

USER GUIDE

h-Knights-RGB



Assembly procedures may vary depending on user preference. Product colors and components are subject to change for quality improvements. For your safety, please wear protective gloves during assembly.

ACCESSORIES

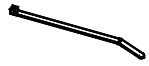

Cable Ties x 5



Thumb Screw x 1



Motherboard Standoffs x 3



PSU / VGA Screws x 7



HDD Screws x 4



SSD / MB Screws x 16

MOTHERBOARD

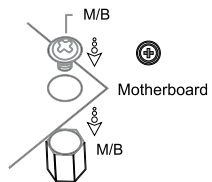

Motherboard Installation:

Install the standoff screws onto the chassis at the designated mounting points. Align the motherboard with the standoffs, then secure it using the provided screws.

IO

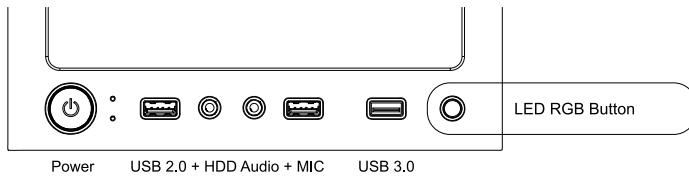

REMOVING SIDE GLASS

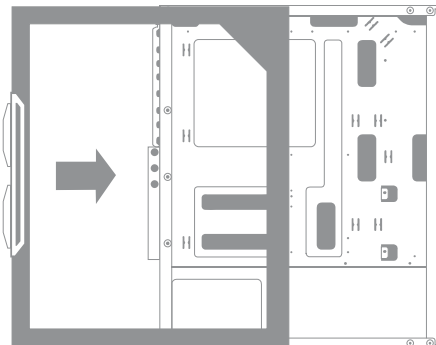

INSIDE CHASSIS

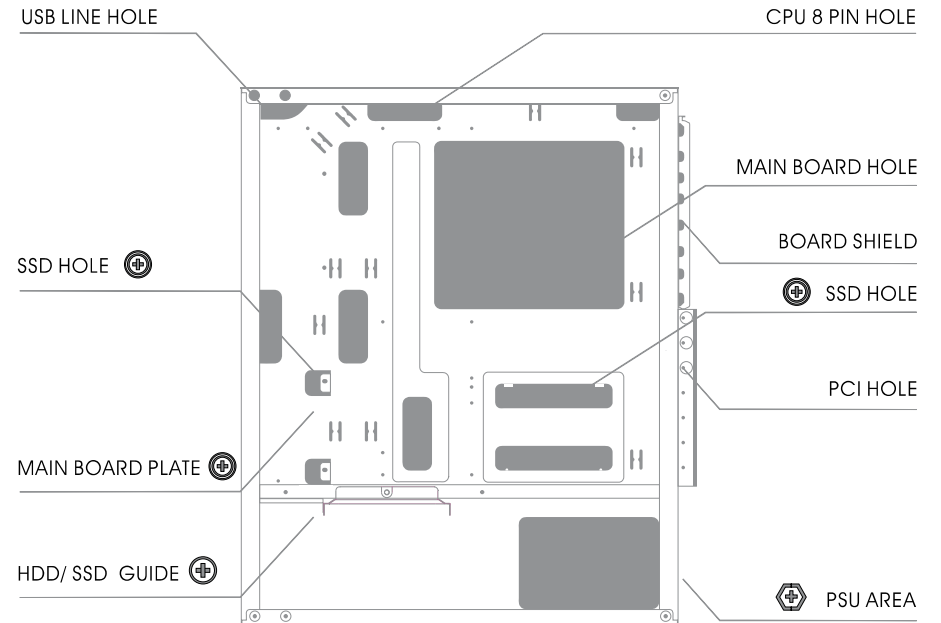

HDD GUIDE

